

ASCENSION PARISH INTERSECTION IMPROVEMENTS

☐ - PROPOSED IMPROVEMENT OF STATE INTERSECTIONS BY ASCENSION PARISH

14 - INTERSECTION OF LA 3089 @ LA 308
LEFT TURN LANES ON LA 3089 (ALL 4 DIRECTIONS)
WIDENING OF BRIDGE OVER BAYOU LAFOURCHE
(ESTIMATED COST = \$1,350,000)

15 - INTERSECTION OF LA 1 (N) @ LA 18
LEFT TURN LANES ON LA 1 (ALL 4 DIRECTIONS)
WIDENING OF BRIDGE OVER BAYOU LAFOURCHE
(ESTIMATED COST = \$1,350,000)

16 - INTERSECTION OF LA 1 (S) @ CYBEAN BRIDGE
LEFT TURN LANE ON LA 1 (SB)
RIGHT TURN LANE ON CYBEAN BRIDGE RD.
RELOCATION AND PAVING ON GRAVEL RD. (N OF LA 1)
(ESTIMATED COST = \$350,000)

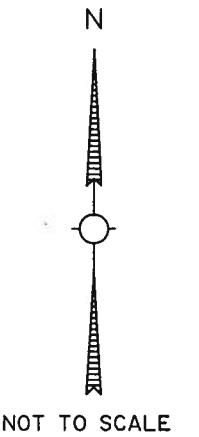
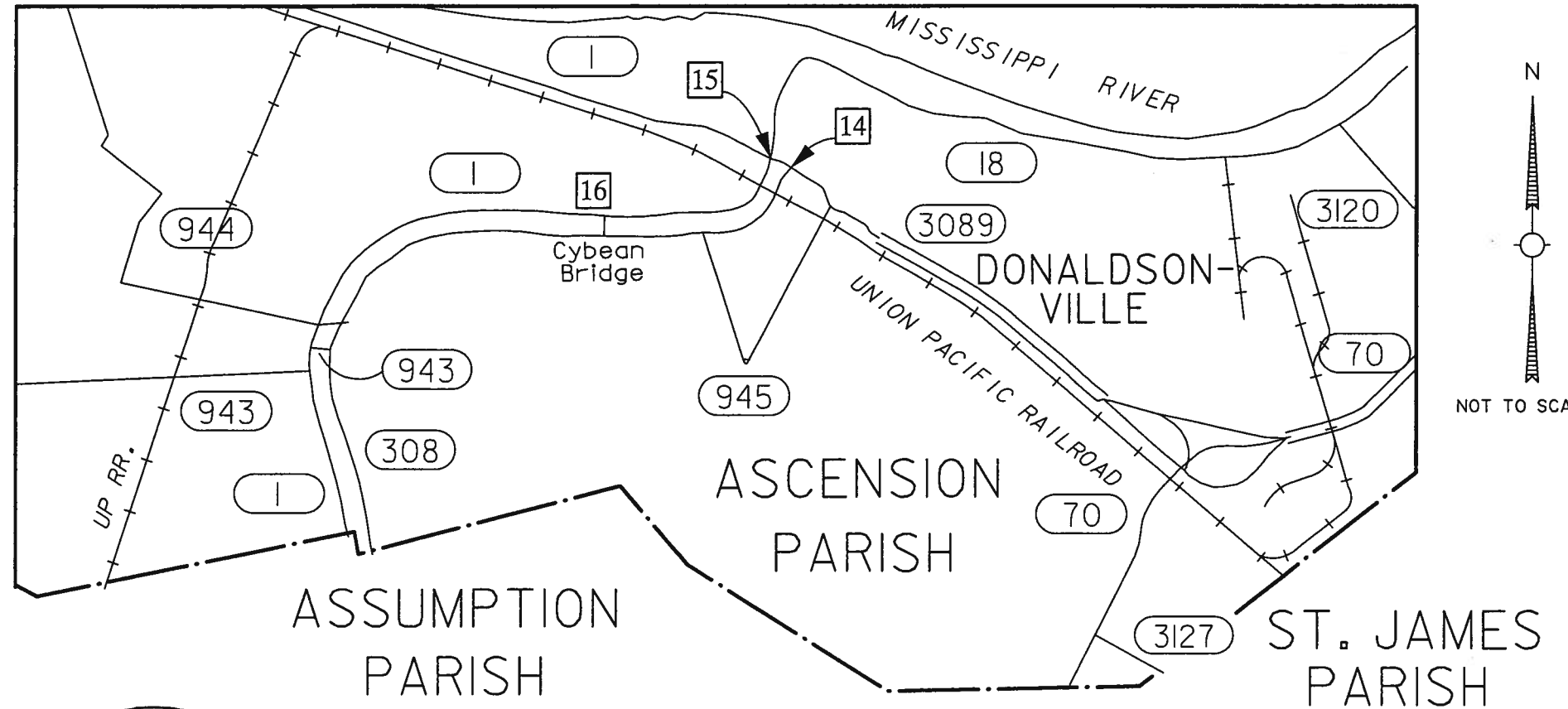

DONALDSONVILLE