

August 31, 2023

ADDENDUM NUMBER TWO

RE: **Butch Gore Park Renovations**
14550 Harry Savoy Road
St. Amant, Louisiana 70774

The following items shall be considered part of the Contract Documents for the above referenced project and shall take precedence over any conflicting statements contained therein. Revise all other notes, schedules, details, etc. as required.

Drawings:

1. Refer to Drawing L7.2 – Details

Refer to the attached revised sheet L7.2 for revisions to add additional clarification to backstop netting system details and product information.

Additional Clarification and RFI Response Items:

2. Question: Is the intent for the infill at the synthetic turf to be all sand or a sand and pea gravel ballast?

The infill for the synthetic turf playing field is intended to be all sand. No pea gravel ballast is required. Refer to specification section 321823 for additional information.

3. Question: What depth and percentage of lime stabilization is needed for the project?

The lime percentage and depth will be determined by the owner's construction material and testing consultant. For bidding purposes, assume 10% by volume at 12" depth.

Prior Approval Items:

4. Specification Section 321823 – Infilled Synthetic Turf

- **Shock Pad**
 - NXTPLAY pad by Shaw Sports Turf is a prior approved manufacturer.
- **Synthetic Turf**
 - Momentum HP by Shaw Sports Turf is a prior approved manufacturer.

End of Addendum No. 2

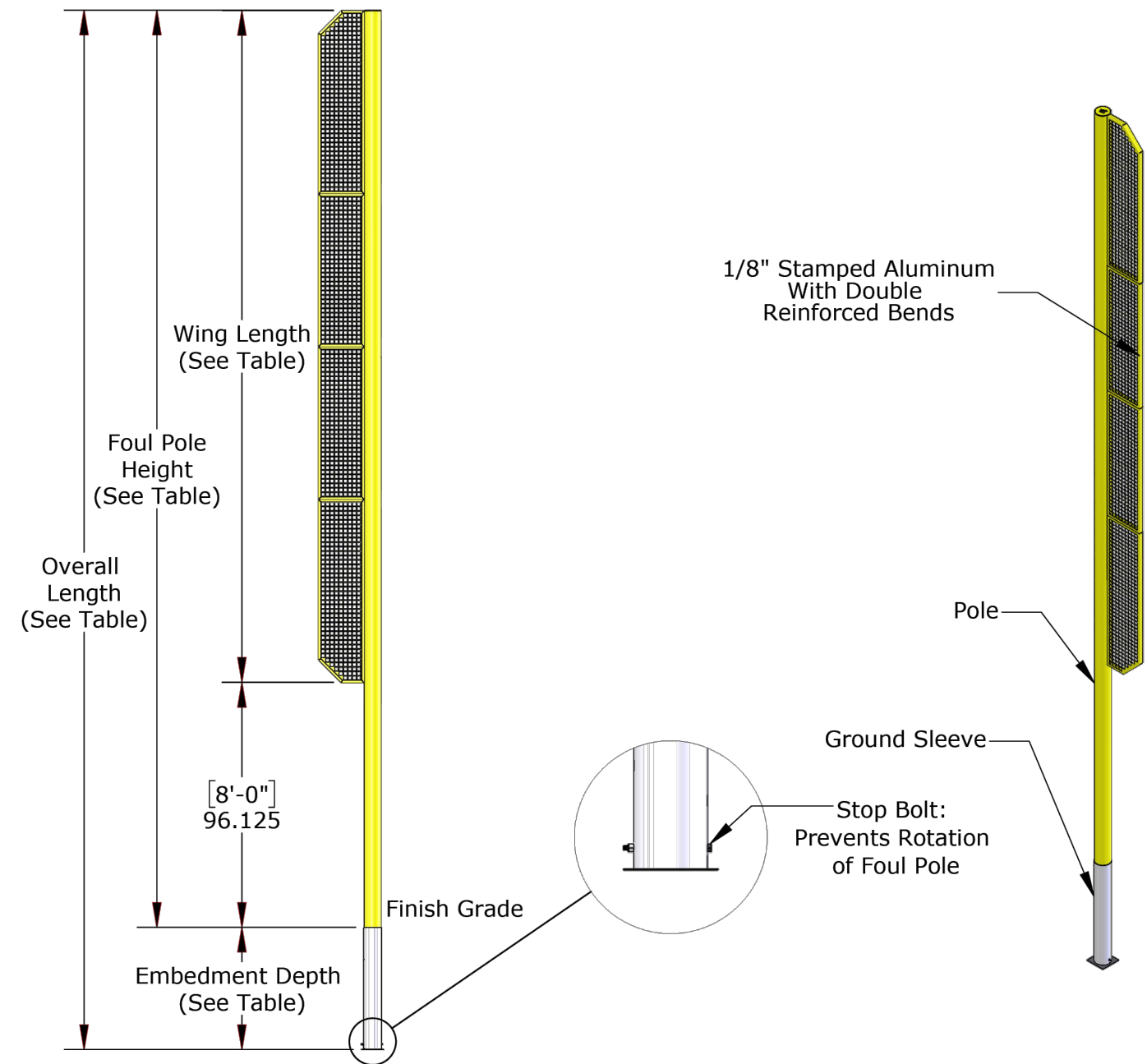

Part No.	Foul Pole Height	Overall Length	Embedment Depth	Wing Length	# of Wing Panels	Pole Material	Minimum Foundation Diameter
FPW415	15'	17'-6"	2'-6"	7'	1	4" OD x 0.125" Wall Aluminum	18"
FPW420	20'	22'-6"	2'-6"	12'	2	4" OD x 0.125" Wall Aluminum	18"
FPW630	30'	34'	4'-0"	22'	4	6-5/8" OD x 0.280" Wall Aluminum	24"
FPW640	40'	44'	4'-0"	32'	6	6-5/8" OD x 0.280" Wall Steel	24"

SPORTSFIELD SPECIALTIES
PRODUCT: GROUND SLEEVE FOUL POLE WITH WING

ITEM NUMBER: FPW415

CONTACT: 1-888-975-3343 - WWW.SPORTSFIELDSPECIALTIES.COM

NOTE:

1. INSTALL PER MANUFACTURER'S INSTRUCTIONS.
2. CONTRACTOR SHALL PROVIDE STAMPED SHOP DRAWINGS WITH FOUNDATION DESIGN FOR REVIEW AND APPROVAL BY LANDSCAPE ARCHITECT.
3. ALTERNATE MANUFACTURERS:
 - AMERICAN SUPER SPORTS
 - JAYPRO SPORTS
 - HAHN ENTERPRISES
 - OR ACCEPTED SUBSTITUTE

SPORTSFIELD SPECIALTIES
PRODUCT: POLE TO POLE TENSION BACKSTOP NETTING SYSTEM

ITEM NUMBER: TNPPUC

CONTACT: 1-888-975-3343 - WWW.SPORTSFIELDSPECIALTIES.COM

NOTE:

1. INSTALL PER MANUFACTURER'S INSTRUCTIONS.
2. CONTRACTOR SHALL PROVIDE STAMPED SHOP DRAWINGS WITH FOUNDATION DESIGN FOR REVIEW AND APPROVAL BY LANDSCAPE ARCHITECT.
3. ALTERNATE MANUFACTURERS:
 - AMERICAN SUPER SPORTS
 - JAYPRO SPORTS
 - HAHN ENTERPRISES
 - OR ACCEPTED SUBSTITUTE

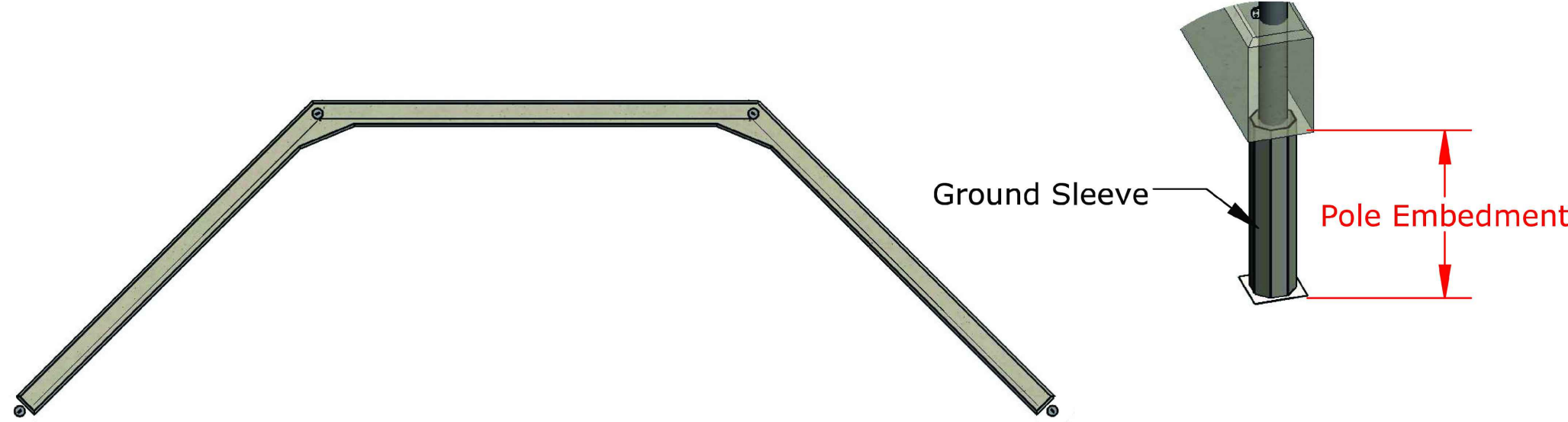
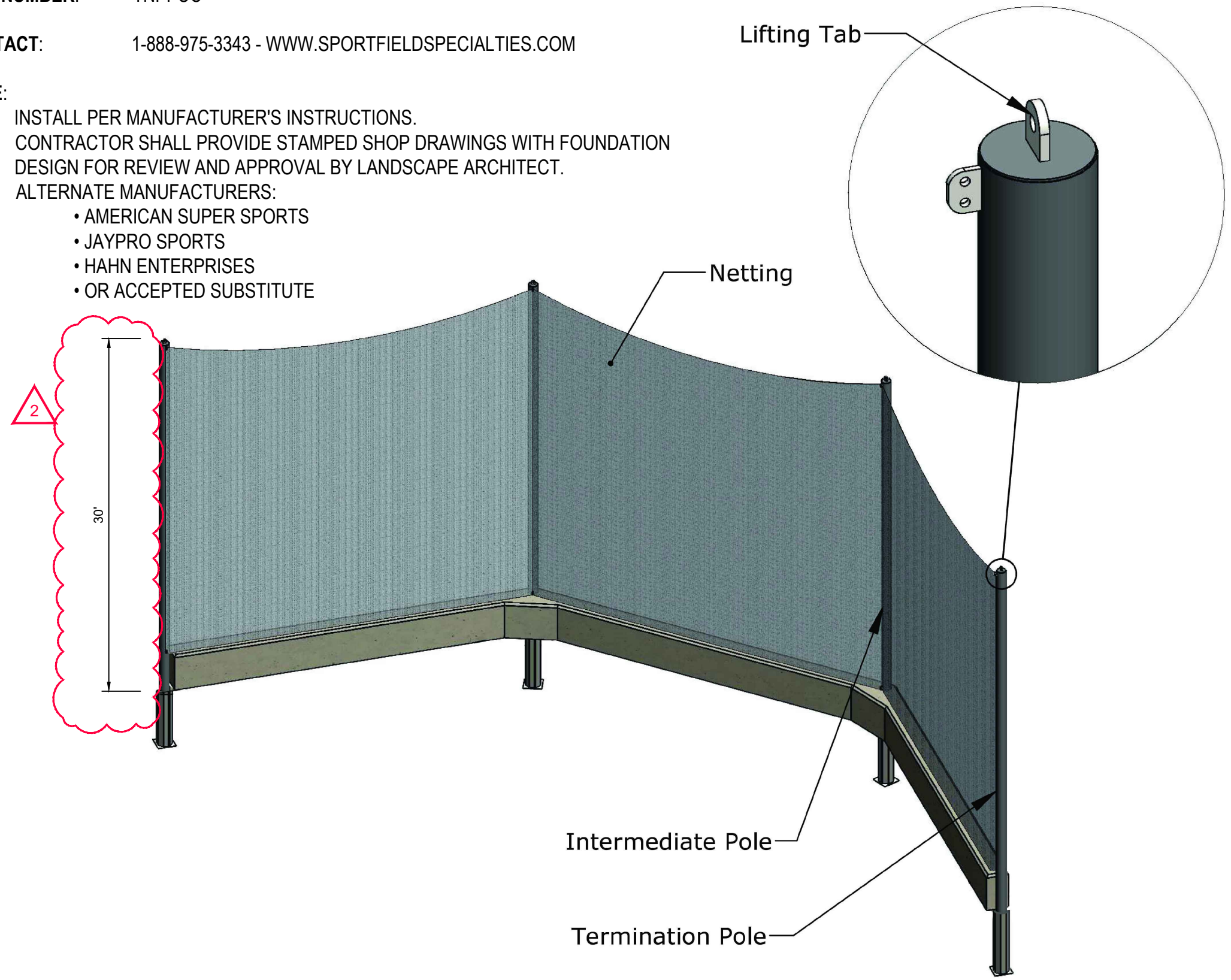

2 POLE TO POLE TENSION NETTING SYSTEM
NTS
VIEW-185074807

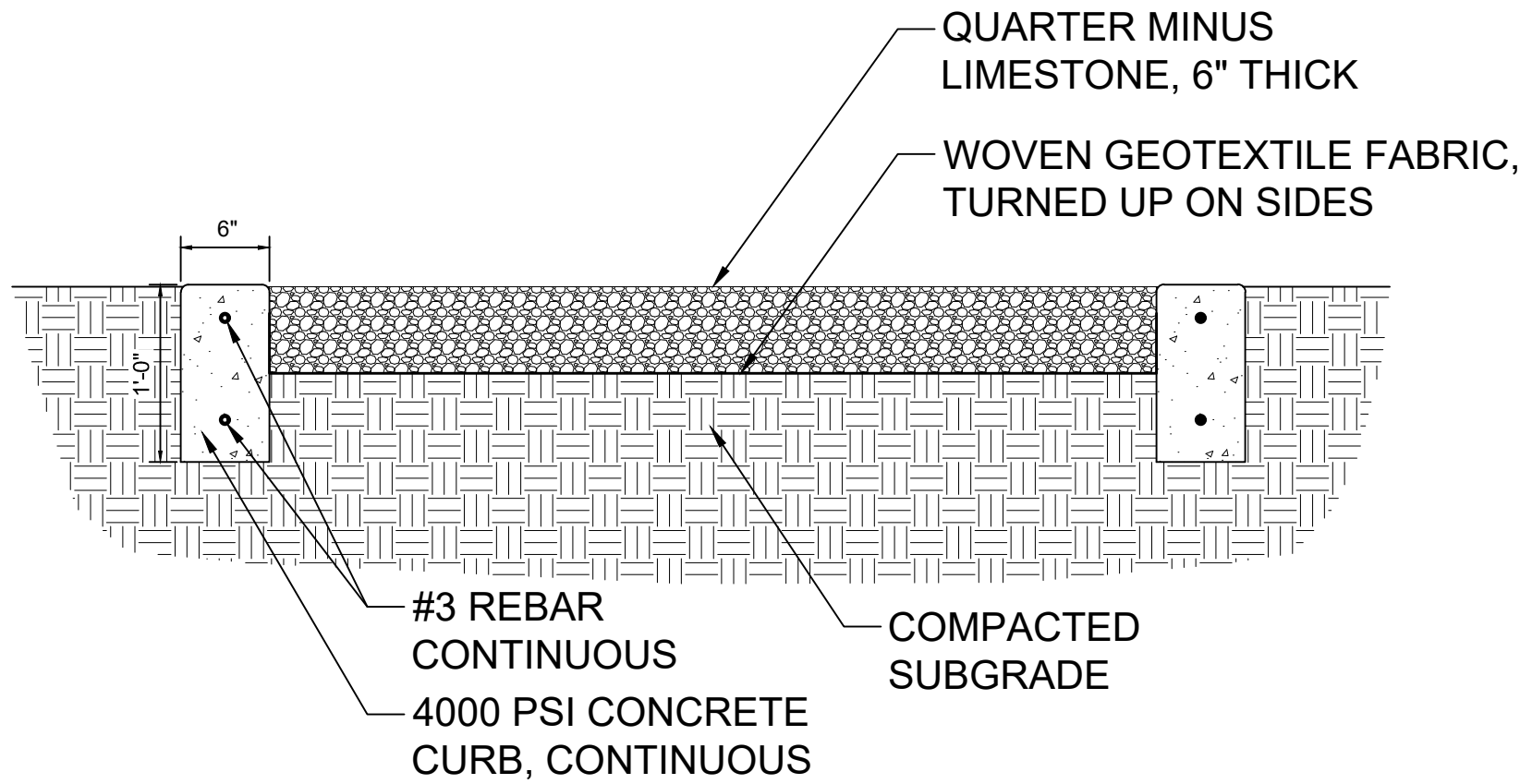

3 WALKING TRAIL SECTION
1\"/>

BID ADDENDUM 2 - 2023-08-31
CLARIFIED HEIGHT OF BACKSTOP NETTING

UTILITY NOTE:
THE CONTRACTOR SHALL BE RESPONSIBLE FOR DETERMINING THE EXACT LOCATION, DEPTH AND SIZE OF ALL UNDERGROUND UTILITIES AND STRUCTURES AND SHALL BE LIABLE FOR ANY DAMAGE CAUSED BY FAILURE TO COMPLY WITH THESE INSTRUCTIONS.

Louisiana 811

BY LAW, ANYONE PLANNING MECHANIZED DIGGING OR EXCAVATION WORK IN LOUISIANA MUST NOTIFY LOUISIANA ONE CALL BY CALLING 811 OR 1-800-272-3020 OR BY GOING TO THEIR WEBSITE AT WWW.LOUISIANA811.COM AT LEAST TWO FULL BUSINESS DAYS PRIOR TO THE PROJECTS START DATE.

Client: **PARISH OF ASCENSION GOVERNMENT**
615 E WORTHY ST.
GONZALES, LA

Project: **BUTCH GORE PARK RENOVATIONS**
14550 HARRY SAVOY RD.
ST. AMANT, LA

Location: LOCATED IN SECTION 12, TOWNSHIP 14 NORTH, RANGE 3 EAST, SOUTHEASTERN PART OF MISSISSIPPI RIVER, ASCENSION PARISH, LOUISIANA

Description: BUILD ONE PARK IMPROVEMENTS

DWG Path: P:\2023 Projects\23-055 - Butch Gore Park Improvements\2 - Landscape Architecture\Drawings\Construction Drawings\23-055-01.dwg

QUALITY ENGINEERING & SURVEYING
18320 Hwy 42, Port Vincent, LA 70775
225.698.1600 | www.qesla.com | info@qesla.com

Stamp: **STATE OF LOUISIANA**
LANDSCAPE ARCHITECT
MICHAEL J. PERRY
00470/23

Drawn By: TT

Date: AUGUST 10, 2023

Project No.: 23-055

Sheets: **L7.2**